

ASSEMBLY INSTRUCTIONS

ITEM DESCRIPTION:

ITEM NO.: DWC33 NAME: Elijah Sconce

MATERIAL TYPE: Glass FINISH: Opal Swirl

SOCKET TYPE: E12 SOCKET QTY: 1

BULB WATTAGE: 60 W/13W CFL/8W LED

VOLTAGE: 110-120 V ITEM NET WEIGHT: 5.0LBS

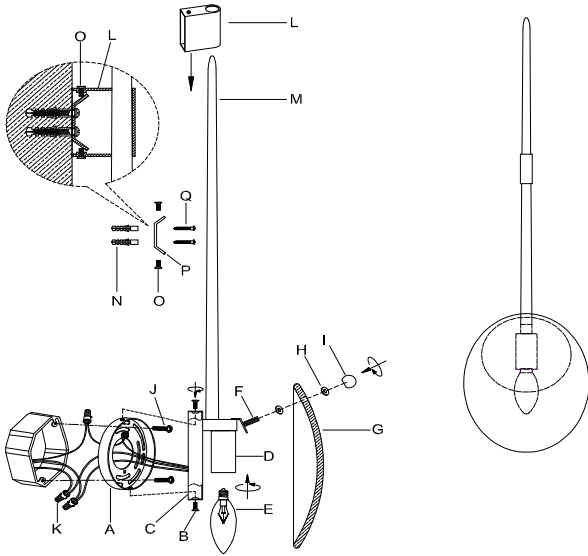

PARTS INCLUDED:

Mounting Plate (A)	Qty: 1 Pc	Metal Finial (I)	Qty: 1 Pc
Set Screws (B)	Qty: 2 Pcs	Metal part (L)	Qty: 1 Pc
Lamp Body (C)	Qty: 1 Pc	Rod (M)	Qty: 1 Pc
Socket (D)	Qty: 1 Pc	Anchor (N)	Qty: 2 Pcs
Bulb (not incl) (E)	Qty: 1 Pc	Screws (O)	Qty: 2 Pcs
Threaded pipe (F)	Qty: 1 Pc	Folding iron (P)	Qty: 1 Pc
Glass Panel (G)	Qty: 1 Pc	Strengthen screws (Q)	Qty: 2 Pcs
Plastic washer (H)	Qty: 1 Pc		

HARDWARE INCLUDED:

Mounting Screws (J) Qty: 2 Pcs
Plastic Wire Connector (K) Qty: 3 Pcs

TOOLS NEEDED (Not Included):

1 Screwdriver

These instructions are provided for safety. It is very important that they are read carefully and completely before beginning installation.

We strongly suggest that all hard-wired fixtures must be installed by a professional electrician.

For customer service questions call 1-800-338-2150



TO ASSEMBLE:

1. Shut off the main electrical supply from the main fuse box/circuit breaker.
2. Please be sure you have all parts indicated before you begin assembly.
3. Attach mounting plate to wall or junction box using mounting screws (J).
4. Connect ground wire from wall to ground wire from lamp using wire connector (K).
5. Attach house wire to lamp wires as shown. Fasten the pairs together with a wire caps. **DO NOT REVERSE THE HOT AND NEUTRAL CONNECTIONS OR SAFETY WILL BE COMPROMISED.**
6. Attach the back plate to mounting plate(A) by inserting set screws(B) through predrilled holes. Tighten using screwdriver.
7. Put the metal part (L) through the rod (M), then attach the metal part (L) 2 holes to the folding iron(P) of the lamp body, then secure with 2 pcs screws (O) until tight.
8. Drill 2 holes in wall align with holes on the metal part(L), then insert anchors (N) into drilled holes, and fasten the folding iron(P) on wall by screwing 2 pcs strengthen screws (Q) provided.
9. Insert 1 type b 60w or/cfl 13w or/led 8w bulb (not included) (E) into the socket (D).Do not exceed specified wattage.
10. Attach the glass panel(G) and plastic washer (H) by tighten the metal finial (I).
11. Restore power to the junction box and test fixture.

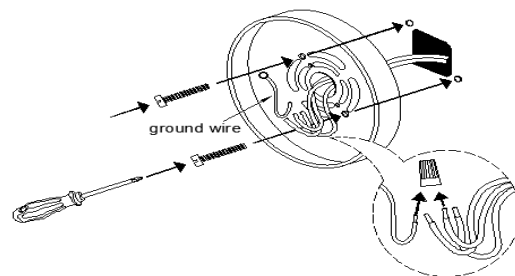
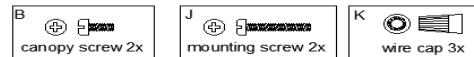

CARE INSTRUCTIONS:

Wipe with a soft, dry cloth. To protect finish, avoid the use of chemicals and household cleaners.

ARTERIOS